

FORM 1—S.T.C.—ROBERTS & SON, BIRMINGHAM

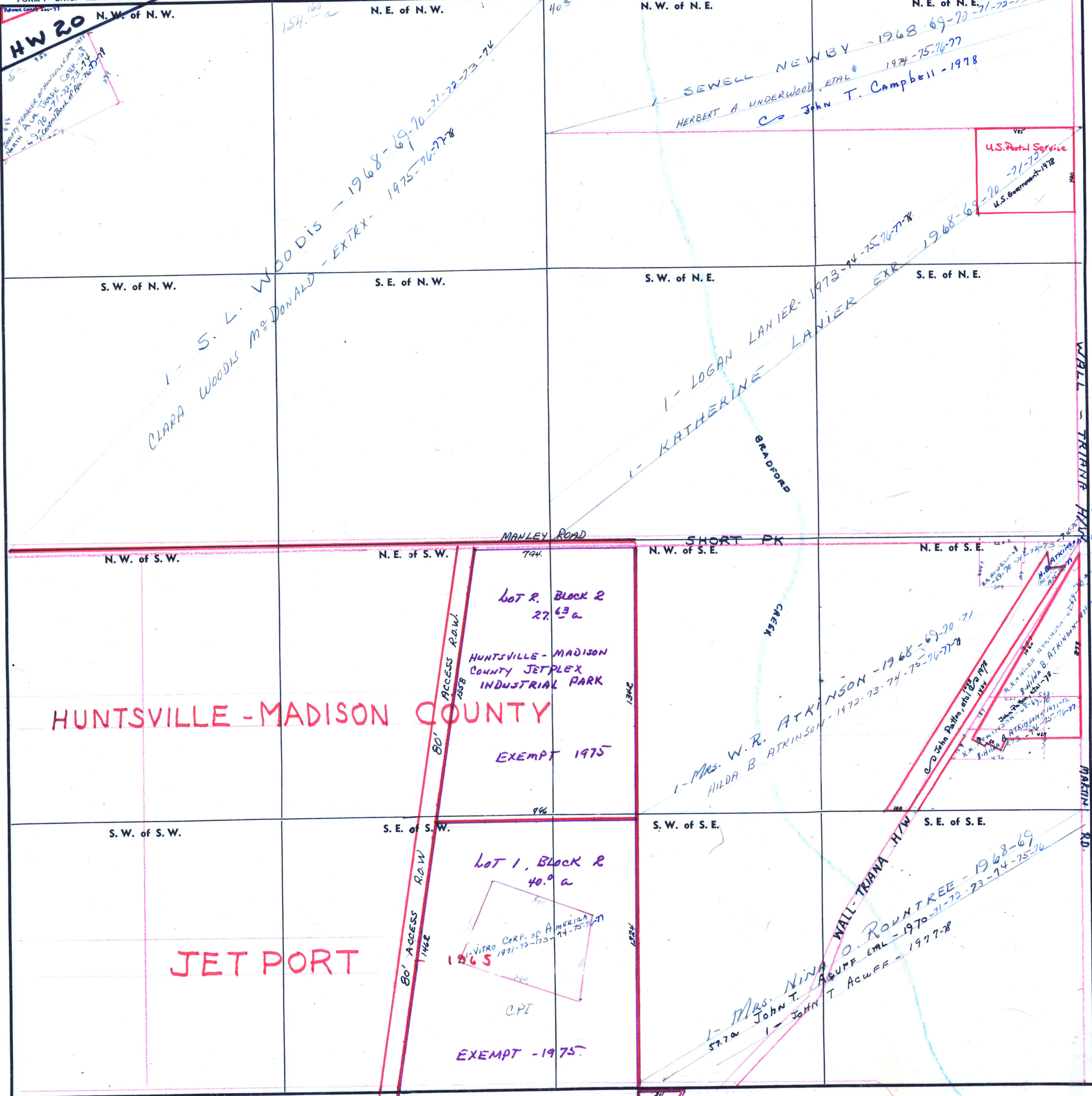

HW 20  
 N.W. of N.W.  
 154.160 a  
 1- S. L. WOODS - 1968-69-70-71-72-73-74  
 CLARA WOODS McDONALD - EXTRX - 1975-76-77-78

N.W. of N.E.  
 N.E. of N.E.  
 1- SEWELL NEWBY - 1968-69-70-71-72-73  
 HERBERT A UNDERWOOD, ETAL 1974-75-76-77  
 John T. Campbell - 1978  
 U.S. Postal Service  
 -71-72  
 U.S. Government - 1978

S.W. of N.W.  
 S.E. of N.W.  
 S.W. of N.E.  
 S.E. of N.E.  
 1- S. L. WOODS  
 CLARA WOODS McDONALD  
 1- LOGAN LANIER - 1973-74-75-76-77-78  
 1- KATHERINE LANIER EXR - 1968-69-70-71-72-73-74-75-76-77-78

N.W. of S.W.  
 N.E. of S.W.  
 N.W. of S.E.  
 N.E. of S.E.  
 HUNTSVILLE - MADISON COUNTY  
 LOT R, BLOCK 2  
 27.63 a  
 HUNTSVILLE - MADISON COUNTY JETPLEX INDUSTRIAL PARK  
 EXEMPT 1975  
 1- MRS. W.R. ATKINSON - 1968-69-70-71  
 HILDA B ATKINSON - 1972-73-74-75-76-77-78  
 WALL - TRIANA HWY

S.W. of S.W.  
 S.E. of S.W.  
 S.W. of S.E.  
 S.E. of S.E.  
 JET PORT  
 LOT 1, BLOCK 2  
 40.0 a  
 VITRO CORP. OF AMERICA  
 1971-72-73-74-75-76-77-78  
 EXEMPT - 1975  
 1- MRS. NINA O. ROUNTREE - 1968-69  
 JOHN T. ACUFF ETAL - 1970-71-72-73-74-75-76  
 JOHN T. ACUFF - 1977-78  
 WALL - TRIANA HWY

30-9-2W  
 (BLDGs. & AIRSTRIP)

Scale—1 inch—300 Ft.

COUNTY

SEC 32 - 4 - 2W