

SECTION

4

SW 1/4

TOWNSHIP

4

RANGE 1W

Form 1-S.T.C. ROBERTS & SON-BIRMINGHAM

UNIVERSITY

OF ALABAMA -1968-

GOVERNORS DRIVE

STATE OF ALABAMA

SW 1/4

Sec. 4, T-4-AW

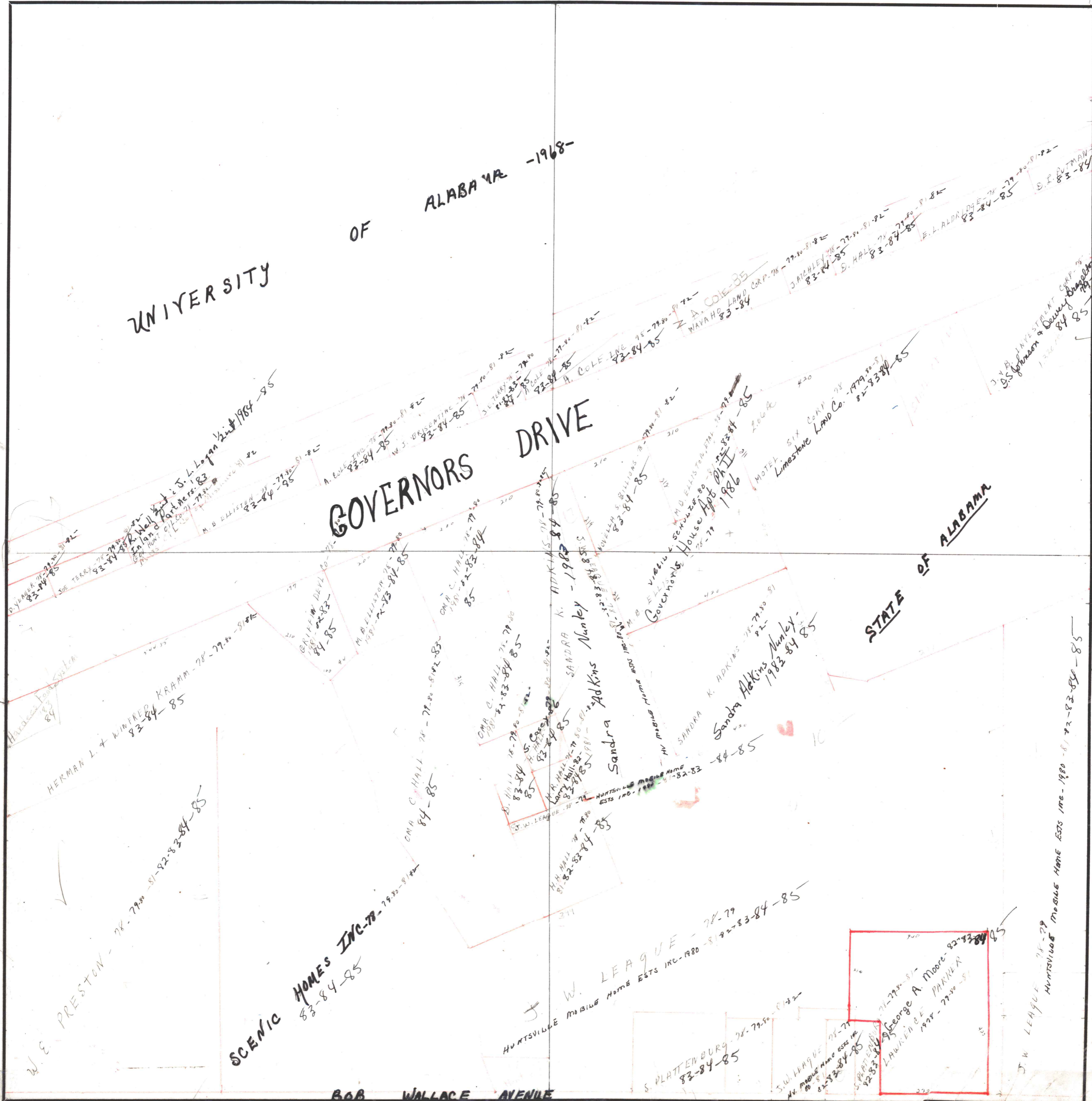

Scale - 1 inch = 150 Ft.

COUNTY Madison

M.M.