

**ORDER: AUTHORIZE CHANGE ORDER NUMBER 2 FOR THE NEW SHERIFF'S DEPARTMENT TO RELOCATE THE LAFAYETTE COUNTY DETENTION CENTER WATERLINE**

Motion was made by Tim Gordon, duly seconded by Scott Allen, to authorize Change Order #2 for the New Sheriff's Department to relocate the Lafayette County Detention Center waterline.

The vote on the motion was as follows:

Supervisor Brent Larson, voted yes  
Supervisor John Morgan, voted yes  
Supervisor Tim Gordon, voted yes  
Supervisor Scott Allen, voted yes  
Supervisor Greg Bynum, voted yes

After the vote, President Larson, declared the motion carried, this the 3<sup>rd</sup> day of June, 2024.



---

**Brent Larson, President  
Board of Supervisors**

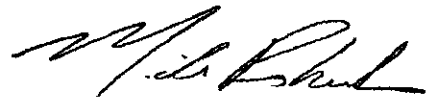

---

**Mike Roberts, Chancery Clerk**



June 3, 2024

Joel Hollowell, Director of Development Services  
Lafayette County  
300 North Lamar Boulevard  
Oxford, MS 38655

RE: A New Sheriff's Department Building  
and Improvements at the Detention  
Center— Phase 2 (Rebid 2)  
Lafayette County Board of Supervisors  
**PCO #3 – LCDC Water Main Relocation**

Dear Joel:

I attach the Contractor's PCO #3 to relocate a portion of the 6-inch water main serving the existing jail. This change is necessary due to an unforeseen latent condition discovered on the morning of May 23, 2024. While performing excavation for the B1 basement level near the W. end of the jail, the Contractor found the existing water main beneath the concrete encased duct bank that previously contained the jail's underground primary electrical service. Underground primary has since been relocated to the E. side of the jail because it fell within the excavation limits of the new building, but the exact location and route of the existing water main was unknown until it was uncovered by the Contractor that Thursday morning.

To address this issue, Elliott & Britt Engineering has proposed to bore approximately 54 lineal feet of new 6-inch HDPE water line between the new building and existing jail (approximately 8-feet to the E. of the B1 basement wall) and tie-in to the existing water main where the existing and new lines intersect to the N. and S. as indicated in the revised utility plan C5.0 issued with RFP#1 (also attached).

The Contractor's total proposed change to the Contract Sum is **\$20,598.91**. 14 additional Days are also included in this PCO to perform the additional work and for processing and/or lead times associated with this work. We have reviewed the proposed costs and additional time requested, found them to be reasonable, and recommend that this proposal be accepted as soon as possible, as this work is on the critical path.

Please advise if you have any questions.

Sincerely yours,

Paul A. Waddell, Assoc. AIA  
Senior Project Manager  
Howorth & Associates Architects

Enclosures



2006 ASPEN COVE · BRANDON, MS · 39042 PHONE: (601) 824-4646 FAX: (601) 824-2211 www.flagstarconstruction.com

June 3, 2024

Attn: Paul Waddell  
Howorth and Associates Architects  
800 North Lamar, Suite 4  
Oxford, MS 38655

Re: LCSD Building and Improvements- Phase 2  
Oxford, Mississippi

Change Proposal 003

Mr. Waddell:

Please accept the following as our proposal for costs associated with the latent six-inch waterline relocation as indicated in RFP #1. The total cost is as follows:

- M&N Excavators, Inc. (Proposal Attached).....\$18,954.60
- Sales Tax (3.5%).....\$663.41
- Subtotal.....\$19,618.01
- P&O (5%).....\$980.90
- Total Cost.....\$20,598.91

This proposal expires in fourteen (14) days. We hereby request the addition of fourteen (14ea) days to the contract duration for processing and completion of this work. Please provide approval status as quickly as possible, as this is currently critical.

Please do not hesitate to call me if you have any questions or need any additional information regarding the above.

Sincerely,

FLAGSTAR CONSTRUCTION COMPANY, INC.



R. Lee Kittrell  
Project Manager



Lafayette County Sheriff's Department		M&N Excavators, Inc.		QUANTITY	UNIT	PER UNIT	TOTAL
ITEM						ESTIMATE	
6" HDPE Water Bore Items							
Tie-In to Existing Water Main	EA	\$ 1,677.00	\$ 3,354.00	2			
6" HDPE Water Bore	LF	\$ 288.90	\$ 15,600.60	54			18,954.60
<b>Added Storm-Drain Items</b>							
12" HP Storm Drain	LF	\$ 54.18	\$ 2,167.20	40			
15" HP Storm Drain	LF	\$ 60.63	\$ 2,425.20	40			
Change From Junction Box To Curb Inlet	EA	\$ 645.00	\$ 645.00	1			
Added Concrete Grate Inlet	Each	\$ 6,053.00	\$ 12,126.00	2			
Concrete Invert	Each	\$ 354.75	\$ 709.50	2			
15" x 15" HP Tee Fitting	EA	\$ 1,386.75	\$ 1,386.75	1			19,459.65
<b>Deleted Storm Drain Items</b>							
15" Nyloplast Drain Basin (0-6')	EA	\$ 3,483.00	\$ 6,966.00	2			(6,966.00)
<b>Clearing Along North Easement Area</b>							
Additional Clearing & Grubbing	LS	\$ 5,160.00	\$ 5,160.00	1			5,160.00
<b>Total Additional Clearing</b>							\$ 5,160.00
<b>Total Change Order</b>							\$ 36,608.25



**PROFESSIONAL'S  
REQUEST FOR PRICING**

---

**PROJECT:** A New Sheriff's Department Building and  
Improvements at the Detention Center— Phase 2 (Rebid 2)  
Lafayette County Board of Supervisors  
Oxford, Mississippi

**PROJECT NO:** 2020-30-2

**RFP NO. 1**

---

**DATE:** May 29, 2024

**PLEASE PROVIDE AN ITEMIZED PROPOSAL THAT INCLUDES THE FOLLOWING:**

Item No. 1 — Furnish all materials and labor required to relocate 6" water line serving existing LCDC building as indicated on attached Sheet C5.0, revised on 5/29/24.

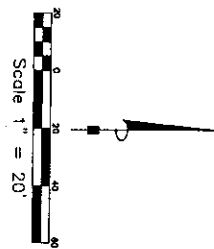

**PROPOSED UTILITY PLAN NOTES**

1. CONTRACTOR SHALL INSTALL WATER AND SEWER UTILITIES ACCORDING TO CITY OF OXFORD SPECIFICATIONS.
2. ALL CONDUIT AND WATER SERVICE TUBING TO BE AT A MINIMUM DEPTH OF AT LEAST 48".
3. ALL SEWER LINES SHOWN HEREON ARE TO BE PRIVATELY MAINTAINED.
4. CONTRACTOR IS TO RELOCATE ALL UTILITY LINES FROM TO CROSSING ANY UTILITY MATERIALS TO FIT SIZE AND LOCATION OF EXISTING UTILITY LINES.
5. FOR PROPOSED WATER CONNECTION INTO BUILDING, SEE PLUMBING SHEET.
6. SEE CONSTRUCTION DETAILS (CD-3) FOR SANITARY SEWER WORK AND WATER WORK.
7. EXISTING POWER POLE TO BE RELOCATED TO COORDINATE RELOCATION WITH CITY OF OXFORD.
8. EXISTING GAS LINE TO BE RELOCATED IF IN CONTACT WITH PROPOSED BRIDGE WORK TO BE PERFORMED BY CENTERPOINT ENERGY.
9. EXISTING GAS LINE TO BE REMOVED IF STILL IN CONTACT. GASES SHOULD BE ABANDONED BY UTILITY COMPANY. CONTACT CENTERPOINT ENERGY TO CORRAL.
10. EXISTING LIGHT POLE TO BE REMOVED.
11. CIVIL SCOPE OF PROPOSED UTILITIES SHALL BE WITHIN FIVE (5) FEET OF THE BUILDING. SEE OTHER DRAWINGS FOR UTILITY CONNECTION.
12. INFORMATION REGARDING THE PRESENCE, SIZE, CHARACTER, AND LOCATION OF EXISTING UNDERGROUND UTILITIES AND STRUCTURES RELATED TO UNDERGROUND AND INFORMATION AND SHALL BE CONSIDERED BY THE CONTRACTOR. THE LOCATION AND ABANDONMENT OF UNDERGROUND UTILITIES AND STRUCTURES RELATED TO UNDERGROUND UTILITIES SHOWN HEREON MAY BE SUBJECT TO CHANGE AND NOT SHOWN MAY BE ENCOUNTERED. THE OWNER, HIS SUPERVISOR, HIS CONSULTANTS AND THE CONTRACTOR SHALL HEREBY DESIGNATE AND INVESTIGATE THAT THE ENGINEER RECORDING THE UNDERGROUND UTILITIES AND STRUCTURES RELATED TO UNDERGROUND UTILITIES SHOWN HEREON.

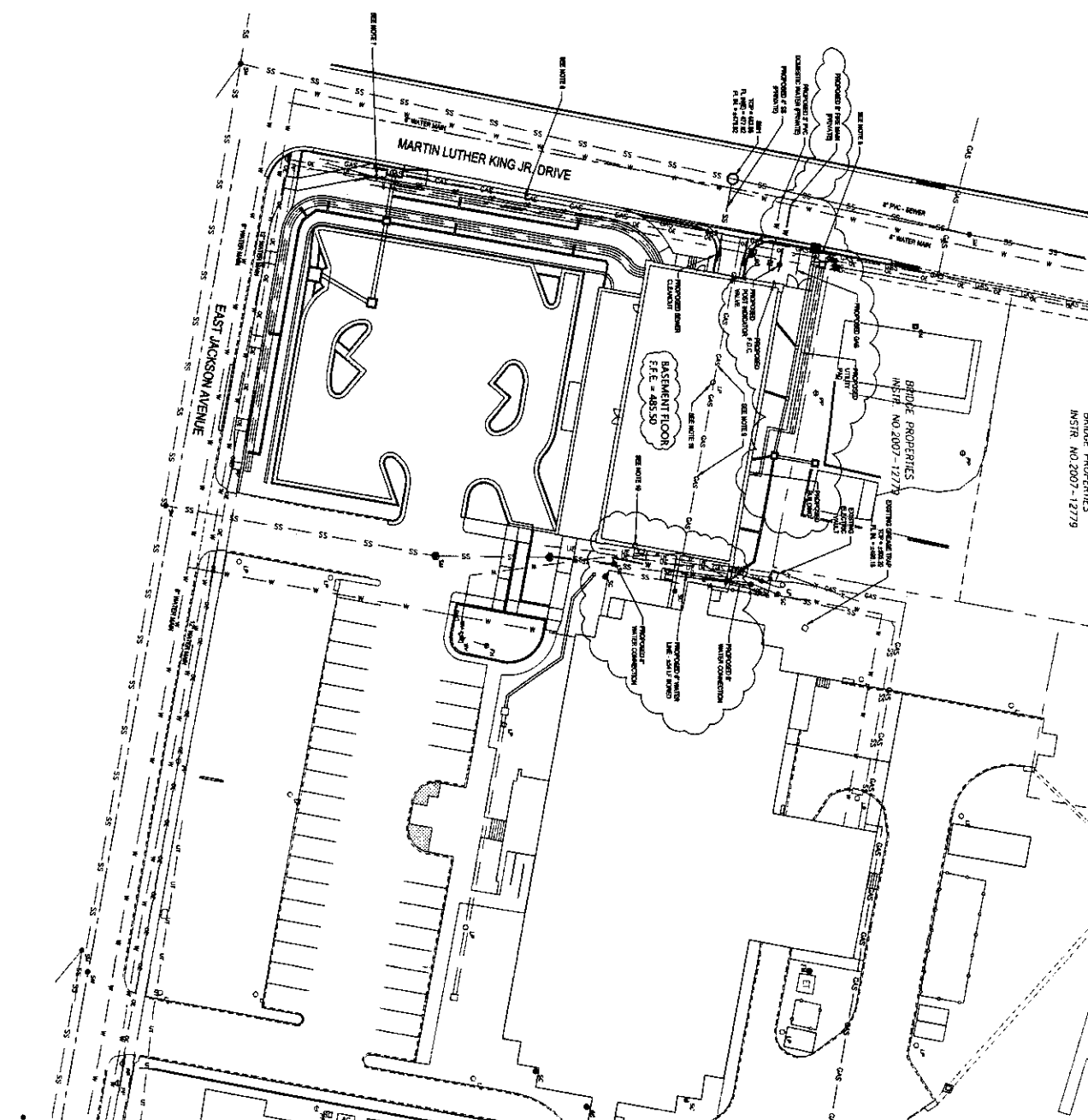

BRIDGE PROPERTIES  
INSR# NO 2007-12779

PROPOSED  
UTILITY PLAN  
SHEET NUMBER  
**C5.0**

A New Sheriff's Department Building and  
Improvements at the Detention Center- Phase 2 (Rebid 2)  
JACKSON AVENUE EAST  
OXFORD, MISSISSIPPI 38655

Consultants:  
**ELLIOTT & BRITT  
ENGINEERING, P.A.**  
10000 Highway 111, Suite 100  
Oxford, Mississippi 38655  
Phone: 662-234-1762  
www.elliottandbritt.com

CONSTRUCTION DOCUMENTS	
ISSUE DATE:	REVISION DATE:
3	4/18/2024
4	5/15/2024
5	5/25/2024

P. N. 2020-30-2



**HAA** HOWORTH & ASSOCIATES  
ARCHITECTS  
PO Box 1549 • Oxford, Mississippi 38655 • 662.234.4444 • www.howorthand.com